

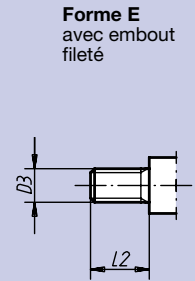

Matière:
Acier.

Finition:
Poli.

Exemple de commande:
nlm 06290-216

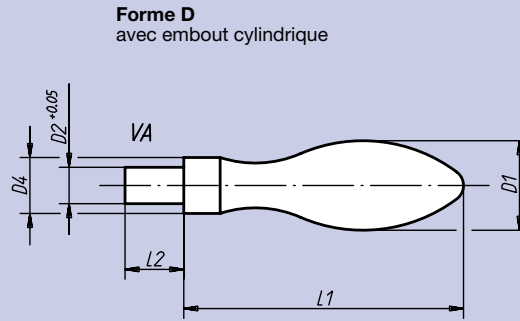
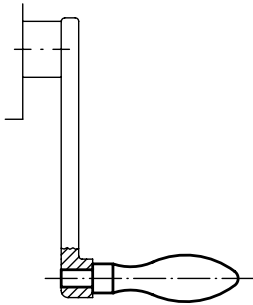

Référence Forme D	Référence Forme E	D ₁	D ₂ ^{+0,05}	D ₃	D ₄	L ₁	L ₂	⊞kg
06290-113	06290-213	13	5	M 5	8	40	10	0,025
06290-116	06290-216	16	6	M 6	10	50	13	0,040
06290-120	06290-220	20	8	M 8	13	64	15	0,090
06290-125	06290-225	25	10	M10	16	80	18	0,175
06290-132	06290-232	32	12	M12	20	100	20	0,355



Matière:
Poignée: acier ou aluminium.
Insert: acier.

Finition:
Poignée: poli.
Insert: bruni.

Exemple de commande:
nlm 06291-0616050

Nota:
Poignée assortie aux volants
DIN 950.

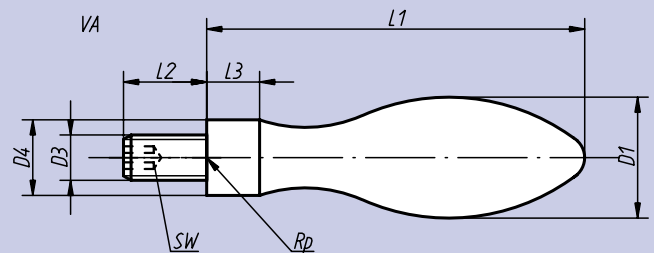

Référence Acier	Aluminium	D ₁	D ₃	D ₄	L ₁	L ₂	L ₃	SW	⊞kg	
								Acier		Alu
06291-0616050	06292-0616050	16	M 6	10	50	11	7	3	0,045	0,020
06291-0820064	06292-0820064	20	M 8	13	64	13	8	4	0,090	0,035
06291-1025080	06292-1025080	25	M10	16	80	14	10	5	0,180	0,075
06291-1232100	06292-1232100	32	M12	20	100	21	13	6	0,360	0,130
06291-1636112	06292-1636112	36	M16	22	112	26	14	8	0,525	0,210